

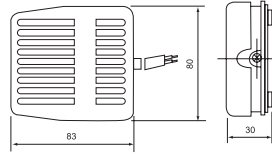

CFS-201

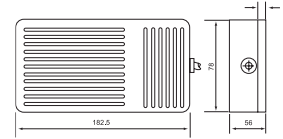

CFS-01



CFS-101 , CFS-102 , CFS-105

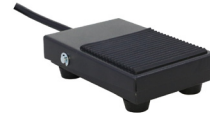
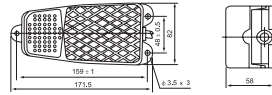

CFS-1

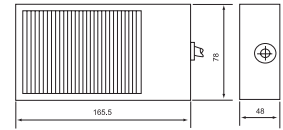

CFS-2

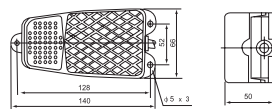

CFS-3 , CFS-3S

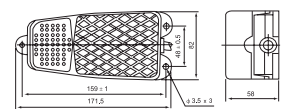

CFS-302

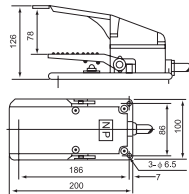

CFS-402

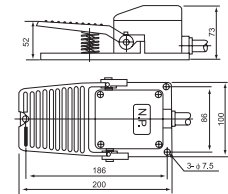

CFS-502

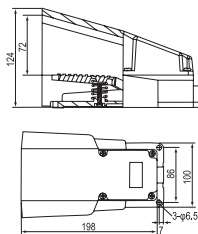

CFS-602

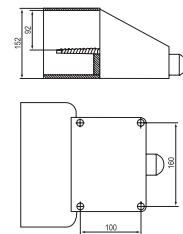

| CFS Series | | | | | |
|--------------|---|-------------------------|---------------|----------------------------------|---------------|
| รุ่น (Model) | Type of switch enclosed & contact arrangement | Rated Current / Voltage | Contact Type | Cable Type / Length | Material |
| CFS-101 | CMV-100D | 10A / 250V | 1A 1B | 0.75mm ² x3C / 1M. | Plastic |
| CFS-102 | CM-1704 | 15A / 250V | 1A 1B | 0.75mm ² x3C / 1M. | |
| CFS-105 | CS-105 | 6A / 250V | Push ON / OFF | 0.75mm ² x2C / 1M. | |
| CFS-2 | CMV-100D | 10A / 250V | 1A 1B | 0.5mm ² x3C / 1M. | Aluminum Cast |
| CFS-3 | CMV-100D | 10A / 250V | 1A 1B | 0.75mm ² x3C / 1M. | |
| CFS-3S | CM-1704 | 15A / 250V | 1A 1B | 0.75mm ² x3C / 1M. | |
| CFS-201 | CMV-100D | 10A / 250V | 1A 1B | 0.5mm ² x3C / 1M. | Plastic |
| CFS-01 | CMV-100D | 10A / 250V | 1A 1B | 0.5mm ² x3C / 1M. | |
| CFS-1 | CMV-100D | 10A / 250V | 1A 1B | 0.5mm ² x3C / 1M. | Iron |
| CFS-302 | CM-1704 | 15A / 250V | 1A 1B | Accessory cable grand (No cable) | Aluminum Cast |
| CFS-402 | CM-1704 | 15A / 250V | 1A 1B | | |
| CFS-502 | CM-1704 | 15A / 250V | 1A 1B | | |
| CFS-602 | Button spring type | 15A / 250V | 2x1A 1B | | |

